



EWELLIX

EWELLIX Linear Actuators

CAR

User Manual

We pioneer motion

SCHAEFFLER

Contents

1	About the manual.....	4
1.1	Information in this user manual.....	4
1.2	Symbols	4
1.3	Signs.....	4
1.4	Legal notices	4
1.5	Liability.....	5
1.6	Availability	5
1.7	Images	5
2	General safety regulations	5
2.1	Intended Use.....	5
2.2	Non-intended Use	6
2.3	Qualified personnel.....	6
2.4	Protective equipment	6
2.5	Hazards.....	7
2.6	Safety regulations.....	7
2.6.1	Commissioning.....	7
2.6.2	Operation	7
2.6.3	Transport and storage.....	8
2.6.4	Maintenance and Repairs	8
3	Scope of delivery.....	8
4	Product description.....	8
4.1	Attachment options.....	9
5	Transport and storage.....	9
6	Mounting	9
6.1	CAR installation.....	10
7	Commissioning	10
8	Operation	10
9	Troubleshooting	11
10	Maintenance	11
11	Disposal	12
12	Technical data	12
12.1	Duty Factor	13
12.2	Circuit Diagrams	14
12.3	Declaration of incorporation.....	15
13	Replacement parts and accessories.....	15
13.1	Replacement parts	15
13.2	Accessories.....	15

1 About the manual

1.1 Information in this user manual

This manual provides important information on how to work with the device safely and efficiently.

The manual is part of the device, must always be kept in the device’s direct proximity and should be available for personnel to read at any time. All personnel working with the device must read and understand this manual before starting any work. Strict compliance with all specified safety notes and instructions is a basic requirement for safety at work.





Moreover, the accident prevention guidelines and general safety regulations applicable at the place of use of the device must also be complied with.

1.2 Symbols

Safety precautions are identified by symbols and signal words as shown. The signal words indicate the severity of the hazard and the chance it could occur. Follow these safety precautions and act cautiously in order to avoid accidents, personal injury and damage to property.

The warning and hazard symbols are defined in accordance with ANSI Z535.6-2011.





☰1 Warning and hazard symbols

Signs and descriptions	
 DANGER	In case of non-compliance, death or serious injury will occur.
 WARNING	In case of non-compliance, death or serious injury may occur.
 CAUTION	In case of non-compliance, minor or moderate injury may occur.
 NOTICE	In case of non-compliance, damage or malfunctions in the product or the adjacent construction may occur.

1.3 Signs

The warning, prohibition, and mandatory signs are defined in accordance with DIN EN ISO 7010 or DIN 4844-2.

☰2 Warning, prohibition, and mandatory signs

Signs and descriptions	
	General warning
	Electrical voltage warning
	Observe the manual
	General mandatory sign

1.4 Legal notices

The information in this manual reflects the status at the time of publication.

Unauthorized modifications to or improper use of the product are not permitted. Schaeffler accepts no liability in these cases.

1.5 Liability

In any case, the owner or the operator of the device is liable for its proper functioning if the device is improperly installed, maintained or repaired by persons who are not part of the Schaeffler Service department, or if the device is used in a manner that does not correspond to its intended use.

Schaeffler shall not be liable for any damage resulting from failure to observe these instructions. These instructions are not to be considered as an extension of the warranty conditions and liability conditions set out in Schaeffler's Terms and Conditions of Sale and Delivery.

The product is not subject to labeling requirements according to CE Directives or EMC Directives. The required EMC measures must be implemented on the end product by the manufacturer of the end product, taking into account the installation conditions, wiring and control, and must be checked in accordance with the intended use.

Compliance with these regulations is the responsibility of the manufacturer of the machine or system.

1.6 Availability



A current version of these instructions is available at:

<https://www.schaeffler.de/std/2229>

Ensure that this manual is always complete and legible and is available to all persons engaged in transporting, fitting, dismantling, commissioning, operating, or maintaining the product.

Keep the manual in a safe place for immediate reference.

1.7 Images

The images in this manual may be schematic representations and may differ from the delivered device.

2 General safety regulations

2.1 Intended Use

The actuator is only intended for use in the following situations:

- Axial loads
- Indoor applications
- Ambient temperature range from -20 °C to $+50\text{ °C}$ (-5 °F to $+122\text{ °F}$)
- Intermittent use

Actuators using one of the following motor series may only be used in an industrial environment.

- D12
- P24

These actuators comply with the emission requirements of EMC generic standard EN 61000-6-4, Emission standard for industrial environments.

The user may need to take suitable measures with regard to emissions if the product is operated in residential, commercial, and light industrial environments in accordance with EMC generic standard EN 61000-6-3.

2.2 Non-intended Use

The device must not be operated in potentially explosive atmospheres.

Do not use the device to lift people.

2.3 Qualified personnel

Operator duties:

- Ensure that only qualified and authorized personnel carry out the activities described in these instructions.
- Ensure that personal protective equipment is used.

Qualified personnel meet the following criteria:

- Product knowledge, e.g. by receiving training on how to use the product
- are fully familiar with the contents of this manual and, in particular, with all of the safety instructions
- are familiar with the relevant country-specific regulations

2.4 Protective equipment

For certain work on the product, suitable protective equipment must be worn. Personal protective equipment consists of:

3 Required personal protective equipment

Personal protective equipment	Mandatory signs in accordance with DIN EN ISO 7010
Protective gloves	
Safety shoes	
Eye protection	

2.5 Hazards

Danger to life caused by electric current

Touching live parts poses an immediate danger to life. Damage to insulation or individual components can also pose a danger to life. Therefore, observe the following:

- Work on the electrical system may only be carried out by electrically skilled persons.
- Disconnect the system from the power supply before performing any work on the electrical system.
- Before maintenance, cleaning, or repair work, disconnect the power supply and secure it against reconnection.

Property damage due to exceeded load limit

- Only operate the actuator within the specified load limits

Property damage due to load

- Always apply load to the actuator centrally
- Only operate the actuator within the specified load limits

Property damage due to overheating

- Reduce time running under load
- Extend rest time

2.6 Safety regulations

The following safety regulations must be observed when working with the product. You can find further information on dangers and specific instructions in other chapters, including those entitled Installation, Commissioning, Operation, and Maintenance.

2.6.1 Commissioning

Only qualified personnel may start up the system.

Disconnect the power supply to the drive before performing installation or maintenance work.

Ensure that the drive is not under load or voltage before installation or maintenance work is performed.

Use suitable safety equipment when installing or maintaining the drive.

The power supply must comply with the technical specifications.

2.6.2 Operation

Exceeding the load limits of the actuator is prohibited. This can lead to serious injuries and material damage. The load limits specified in the technical data need to be observed.

Avoid moving the actuator to the mechanical end position. Repeatedly moving the actuator to the mechanical end position can damage it or shorten its operating life.

The motor and surrounding components can become hot under high loads and during a high duty cycle.

Do not operate the brake separately when the actuator is under load.

2.6.3 Transport and storage

The product may only be transported and stored in its original packaging and under the permissible ambient conditions, see *Technical data*.

Damage due to improper transport

Proceed with caution when unloading the packaged goods, during delivery, and during transport to the destination. Observe the symbols and instructions on the packaging. Do not remove the product from the packaging until immediately before installation.

2.6.4 Maintenance and Repairs

Maintenance work and repairs may only be carried out by qualified personnel.

Disconnect the power supply to the drive before performing installation or maintenance work.

Ensure that the drive is not under load or voltage before installation or maintenance work is performed.

Use suitable safety equipment when installing or maintaining the drive.

3 Scope of delivery

CAR22, CAR32 und CAR40

- Actuator
- User manual
- optional: motor
- optional: attachment

CARN32, CCBR32

- Actuator
- User manual
- optional: attachment

4 Product description

The modular concept of EWELLIX linear actuator CAR simplifies the replacement of critical components such as motors, gearboxes, spindles, or attachments. Customer-specific linear actuators can easily be assembled from standard components to reduce expenses.

The CAR32 and CAR40 actuators are available in the following designs:

- DC: 12 V, 24 V
- AC: 120 V, 230 V

The CAR22 actuator is available in the following designs:

- DC: 12 V, 24 V

The CARN32 and CCBR32 actuators are available in the following designs:

- without motor

4.1 Attachment options

When attached, the maximum angle between the actuator and the rear attachment must not exceed 30°.

1 Maximum admissible attachment angle

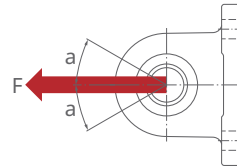

001C33F3

a	°	Max. admissible attachment angle 30°
F	N	Force

Make sure that the force exerted on the attachments is always centered on the actuator.

2 Force applied to the actuator always centered

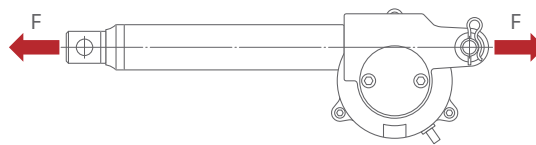

001C33F5

F	N	Force
---	---	-------

5 Transport and storage

Observe the safety regulations for transport.

Observe the safety regulations for the storage.

6 Mounting

The surface the actuator is attached to must be able to withstand the force exerted by the actuator.

6.1 CAR installation

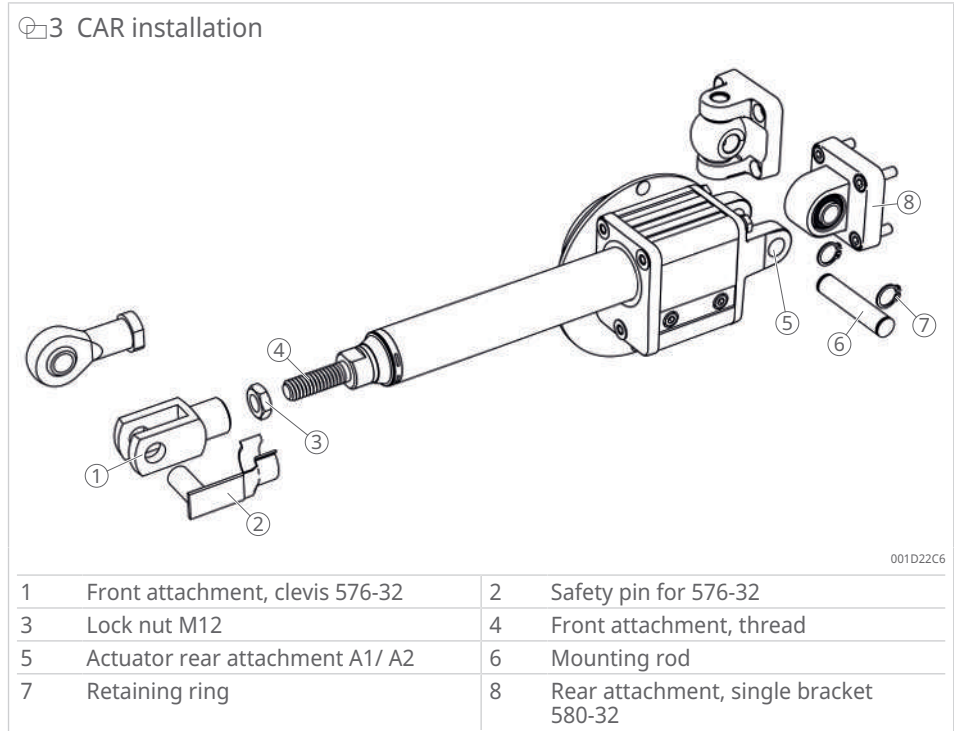

1. Screw the lock nut (3) onto the actuator front attachment (4).
2. Screw the front attachment (1, 2) onto the actuator front attachment (4). The engaging thread length must be at least 12 mm, which is the diameter of the thread.
3. Tighten the front attachment (1) with the lock nut (3) to 20 Nm.
4. Remove the safety pin (2) from the front attachment (1).
5. Install the actuator onto the front and rear attachments. Mount the safety pin (2) onto the front attachment (1). Mount rod (6) with retaining rings (7) onto the rear attachments (5) and (8)

7 Commissioning

- Only qualified personnel may start up the system.
 The power supply must comply with the technical specifications.
1. Disconnect the power supply for the actuator before installation.
 2. Make sure that the actuator is not under load or voltage.
 3. Use suitable safety equipment.

8 Operation

! Avoid moving the actuator to the mechanical end position. Repeatedly moving the actuator to the mechanical end position can damage it or shorten its operating life.

! WARNING	Load limit exceeded Risk of injury ▶ Observe the load limits specified in the technical data.
------------------	--

NOTICE

Load limit exceeded



Material damage to the actuator

- Observe the load limits specified in the technical data.

The motor and surrounding components can become hot under high loads and during a high duty cycle.

Do not operate the brake separately when the actuator is under load.

9 Troubleshooting

WARNING



Live components

Risk of injury due to electric shock

- Disconnect the devices from the supply voltage before carrying out any work on the drive or control unit.

4 Malfunction

Malfunction	Possible cause	Remedy
Greatly increased running noises	Motor, actuator, or nut defective	<ul style="list-style-type: none"> ▸ Stop operation immediately. ▸ Send the actuator to Schaeffler immediately.
Wobbling actuator movement	Excessive load	<ul style="list-style-type: none"> ▸ Stop operation immediately.

If a malfunction cannot be rectified with the measures described, contact Schaeffler Service.

10 Maintenance

Maintenance work and repairs may only be carried out by qualified personnel.

1. Disconnect the power supply for the actuator before maintenance work and repairs.
2. Make sure that the actuator is not under load or voltage.
3. Use suitable safety equipment.

DANGER



Risk of fatal injury from unauthorized reconnection of the power supply

Risk of fatal injury to persons in the hazard area due to moving parts or electric shock if the power supply is switched on without authorization during work on the system and causes the system to restart.

- Before starting work, switch off the system and secure it against reconnection.

5 Maintenance plan

Activity	daily	monthly	every 6 months	annually
Check the device for visible damage	✓			
Remove any dust and dirt	✓			
Check attachments and tighten them if necessary		✓		
Check cables for damage and replace them if necessary		✓		
Check special equipment for visible damage and replace it if necessary		✓		
Functional test		✓		
Add a few drops of oil to the adjustment tube			✓	
Check labels				✓
Check electrical connections				✓

11 Disposal

Observe the local regulations for disposal.

As the actuator is principally made of steel and stainless steel, it may have some grease or oil inside. When disposed of, the motor and some accessories – such as limit switches and encoders – are treated as electronic scrap.

12 Technical data

All values for standard actuators are tested under the following conditions:

- Temperature +20 °C (+68 °F)
- Stabilized voltage
- Compression load

6 Technical data, CAR, DC versions

Characteristic	Unit	CAR22	CAR32	CAR40	CARN32	CCBR32
Voltage supply	–	DC	DC	DC	DC	DC
Voltage	V	12 24	12 24	24	–	–
Current consumption	A	10 4	13 8 5 ¹⁾	16	–	–
Type of protection	–	IP44	IP20, IP44	IP20, IP44	–	–
Rated push load	N	1000 ... 1500	1000 ... 3500	2000 ... 6000	3500	2500
Rated pull load	N	1000 ... 1500	1000 ... 3500	2000 ... 6000	3500	2500
Speed (full load to no load) ²⁾	mm/s	11 ... 35	5 ... 60	10 ... 60	–	–
Stroke S	mm	50 ... 300	50 ... 700	100 ... 700	50 ... 700	50 ... 700
Retracted length L	mm	S + 205	S + 218	S + 263	S + 218	S + 177
Power consumption	W	120	–	–	–	–
Duty cycle	%	25	25	25	–	–
Ambient temperature	°C	–20 ... +70	–20 ... +70	–20 ... +70	–20 ... +70	–20 ... +70
Weight	kg	1.2 ... 1.6	2.1 ... 3.7	5.8 ... 8.4	0.8 ... 3.3	1.1 ... 1.5

1) for motor D24CW

2) Depending on the motor selected

7 Technical data, CAR, AC versions

Characteristic	Unit	CAR32	CAR40
Voltage supply	–	AC	AC
Voltage	V	120 230	120 230
Power consumption	W	98	360
Power consumption, braking	W	133.2	299
Current consumption	A	0.82	3
Current consumption, braking	A	1.11	1.3
Type of protection	–	IP20, IP54	IP20, IP54
Rated push load	N	1500 ... 3500	2000 ... 6000
Rated pull load	N	1500 ... 3500	2000 ... 6000
Speed ³⁾ (full load to no load)	mm/s	6 ... 32	9 ... 40
Stroke S	mm	50 ... 700	100 ... 700
Retracted length L	mm	S + 218	S + 263
Duty cycle	%	30	40
Ambient temperature	°C	–20 ... +70	–20 ... +70
Weight	kg	2.1 ... 3.7	5.8 ... 8.4

3) Depending on the motor selected

12.1 Duty Factor

The permissible load depends on the duty factor, i.e., the load must be reduced if the duty factor is increased. The duty factor is defined as the time running under load in relation to the total cycle time.

11 Determining the duty factor

$$D = \frac{N}{N+R} \cdot 100$$

D	%	Duty factor
N	s	Time running under load
N+R	s	Total cycle time
R	s	Rest time

NOTICE



Duty factor exceeded

Material damage to the actuator due to overheating

- ▶ Reduce running under load
- ▶ Extend rest time

4 Definition of duty factor

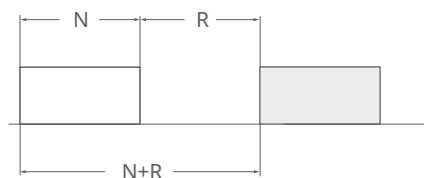

001C33FO

N	s	Time running under load
N+R	s	Total cycle time
R	s	Rest time

DC versions

The admissible load for DC actuators at a given duty cycle is expressed as a percentage of the maximum dynamic load-carrying capacity

8 Duty factor for DC versions at +20 °C (+68 °F)

Actuator	Max. duty factor at max. dynamic load
CAR22	25 %
CAR32	25 %
CAR40	25 %

AC versions

The diagrams show the maximum load as a function of the duty cycle.

The diagrams show how the actuators work when using different capacitors with single-phase motors E220C and E110C.

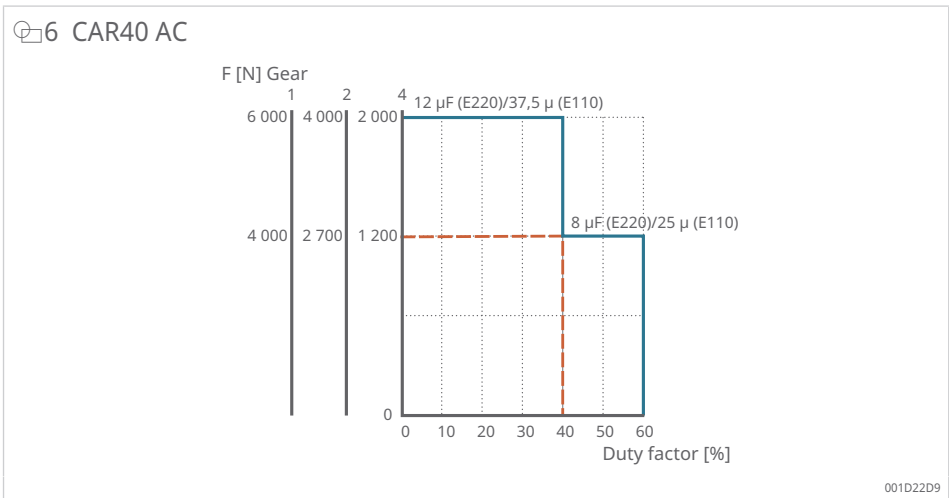
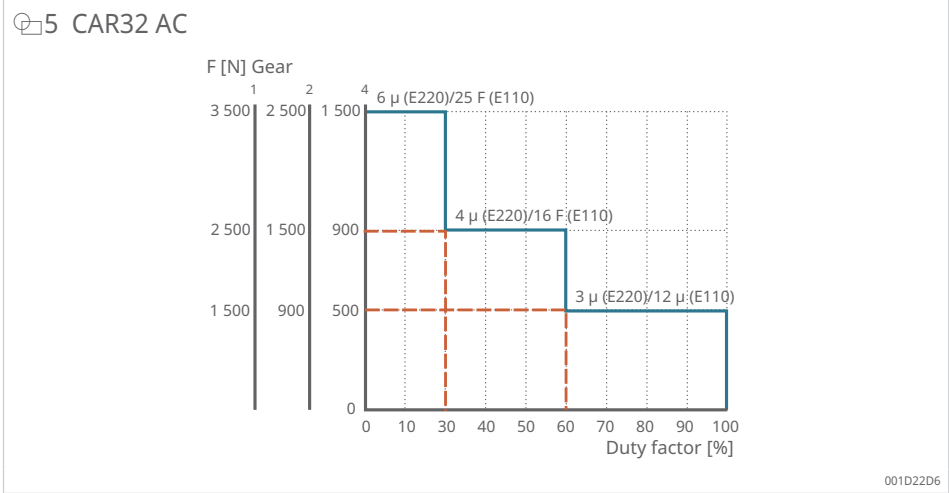

12.2 Circuit Diagrams

Complete installation instructions for the limit switch can be found in the separate installation instructions.

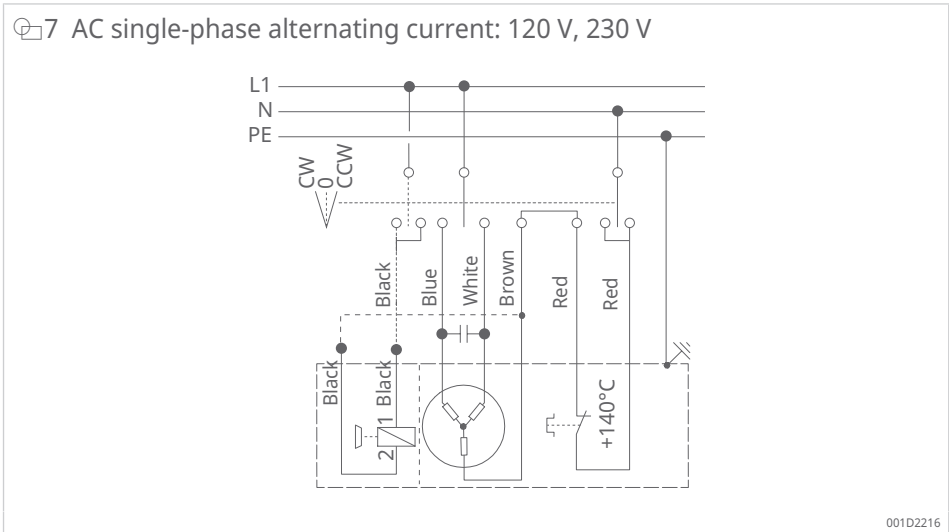

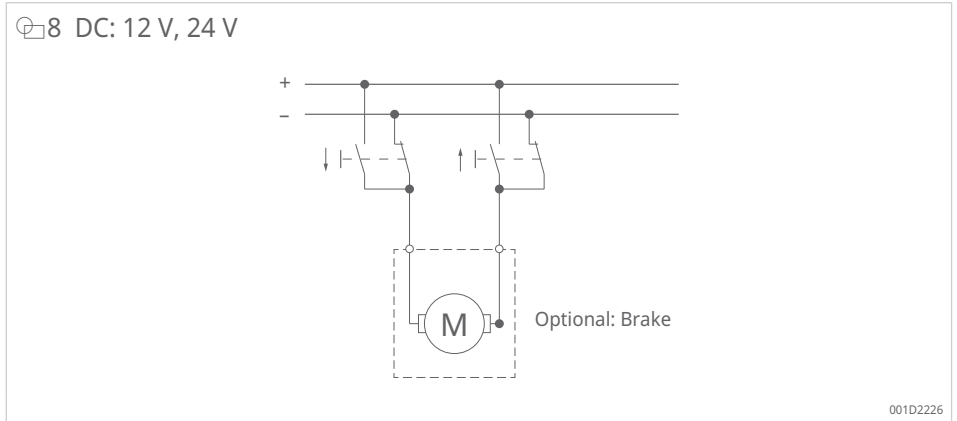

12.3 Declaration of incorporation

CAR |

<https://www.schaeffler.de/std/228B>

13 Replacement parts and accessories

13.1 Replacement parts

If you require additional information or replacement parts, please contact Schaeffler.

13.2 Accessories

- Limit switch

Schaeffler Technologies AG & Co. KG

Georg-Schäfer-Straße 30

97421 Schweinfurt

Germany

www.schaeffler.de/en

info.de@schaeffler.com

In Germany:

Phone 0180 5003872

From other countries:

Phone +49 9721 91-0

All information has been carefully compiled and checked by us, but we cannot guarantee complete accuracy. We reserve the right to make corrections. Therefore, please always check whether more up-to-date or amended information is available. This publication supersedes all deviating information from older publications. Printing, including excerpts, is only permitted with our approval.
© Schaeffler Technologies AG & Co. KG
BA 137 / 01 / en-US / 2026-04